

TABLE LAMP FUSA

DESIGNER: LUCA NICHETTO, 2019

Designer Luca Nichetto has created the colourful Fusa collection exclusively for Svenskt Tenn. His inspiration sprung from Josef Frank's Terrazzo textile print, where the striking stone formations formed the basis for Nichetto's original glass form. To attain all of the colours he needed, he used the colour dye that was left over from different glass manufacturers in Murano. Instead of going to waste, these colours have been processed, refined and reused. All of the items in the collection are handmade at the NasonMoretti glassworks, founded in Murano in 1923.

ITEM NR:	109483, 109484
HEIGHT:	45 CM
DIAMETER:	31 CM
MATERIAL:	GLASS, BRASS & LED
BURN TIME:	50 000 HOURS



GREEN



NEUTRAL

HANDMADE IN ITALY

S V E N S K T T E N N

INSTRUCTIONS

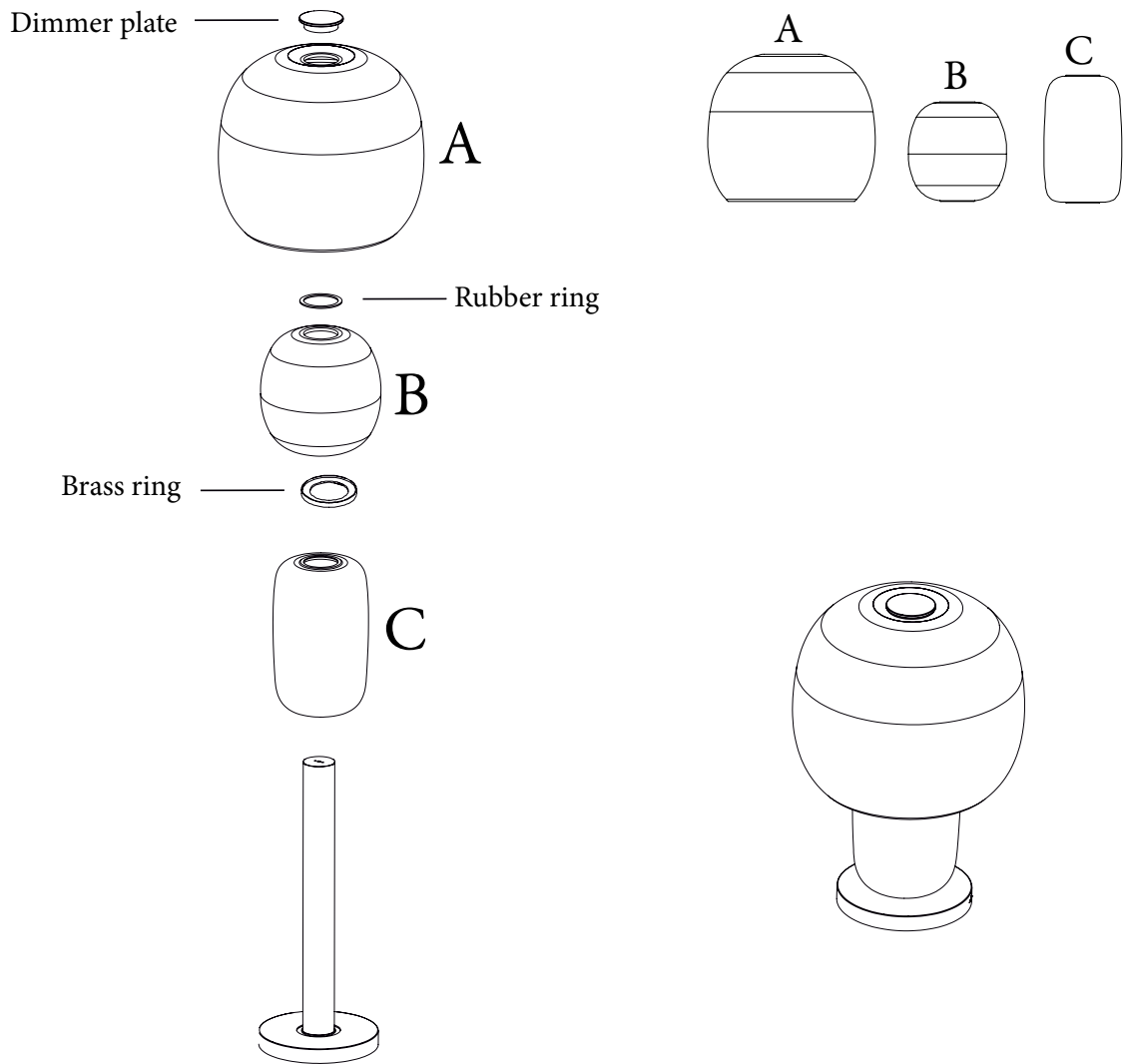

INSTRUCTIONS

INCLUDED

Glass spheres
Light source
Rubber ring
Brass rings with rubberized surface

DIMMER

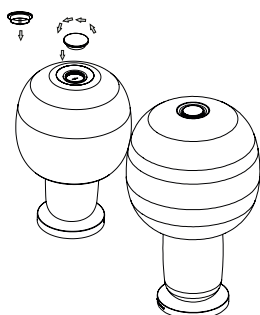

Screw the dimmer plate onto the top of the lamp.

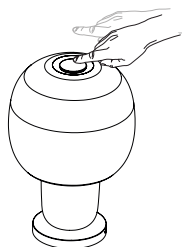

Tap once to turn on the light. Tap again to switch it off.

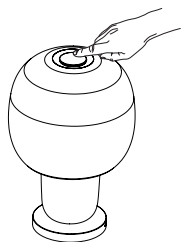

A prolonged contact with the sensor dimmes the light.
The lamp will blink when you reached maximum light intensity.

The lamp will come on at the same light intensity as when it was switched off.

INSTRUCTIONS

INFORMATION

There will be some variation in the glass globes, both in pattern and in shape, as each globe is hand-blown and therefore unique.

Assemble the lamp in the same location as its final position. After being assembled, the lamp will be heavy and difficult to move and may even damage the lamp.

CARE INSTRUCTIONS

Wipe the glass with a soft damp cloth. Avoid contact with water.

When the light source is consumed or if it breaks, please contact Svenskt Tenn or an authorised electrician.